

HOME USAGE ENVIRONMENT

Tudelü system's offer homeowners greater flexibility in how they use and enjoy their living spaces. Whether for creating privacy, optimizing space, or enhancing the home's aesthetics, retractable walls are a practical addition to any modern home.

TUDELÜ SYSTEM BENEFITS

1 SPACE FLEXIBILITY

Retractable walls allow homeowners to create adaptable spaces, such as turning an open-plan living area into separate rooms (e.g., a home office, playroom, or guest room) when needed. This is ideal for small homes or apartments where maximizing space is important.

2 COST-EFFECTIVE SOLUTION

Retractable walls provide an affordable solution for homeowners seeking to enhance their living space without committing to expensive structural changes or permanent room additions.

3 DURABILITY AND SAFETY

The systems are designed to be safe, with secure locking mechanisms to prevent accidental movement, and rounded edges or other safety features to minimize the risk of injury, especially in households with children or pets.

OUR SERVICES



AMERICAN

Engineering, design, and manufacture all done in the USA



MOTORIZED

100% remote controlled for zero manual effort



COMPACT

Full system has tiny footprint in ceiling, starting from 10" x 10"



INSTALLABLE

Easy install for new construction and retrofitting



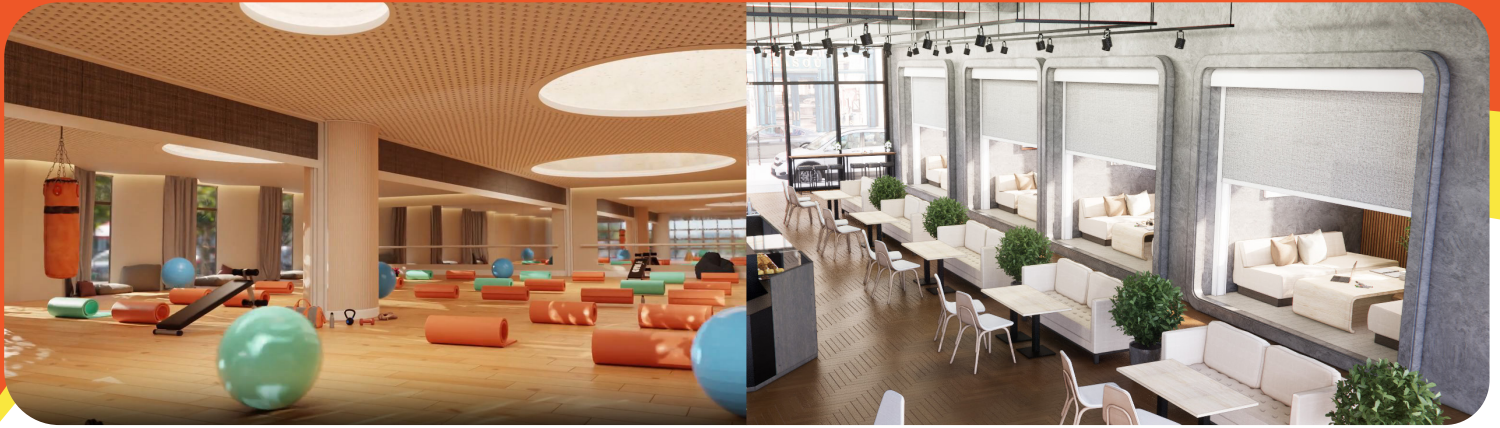

Key Benefits of the Tudelü Systems

Customizable Sizes of up to 20ft wide x 10ft tall

36 - 48 True STC sound barrier for effective sound reduction. This is the same noise reduction as traditional dry wall.

Easy Installation, either through Tudelü direct or through our step-by-step instructions.

100% Motorized - anyone can operate this product with a simple press of a button.

Durable Material - including powder coated extruded aluminum.

Patented Technology - including Stable Griprail Technology.

Compact Footprint - featuring inset design options, meaning ZERO eye sores.

Seamless Design - No matter your dimensions, Tudelü walls won't hurt your aesthetic.

Built-in Safety - auto open feature when the system feels the slightest resistance, so you and your furniture are both safe.

Easy Maintenance - simple soap and water will keep your system looking new for years to come.

| Technical Information | Closure | Private | Secluded | Mute |
|--------------------------------------------|--------------|------------|------------|------------|
| STC of System | - | 36 | 38 | 48 |
| OTC of System | - | 22 | 30 | 30 |
| Max Height in feet | 10' | 10' | 12' | 15' |
| Max Width in feet | 20' | 20' | 20' | 40' |
| Wall Thickness in inches | 2" | 4" | 4" | 4" |
| Weight of Wall Fabric in lbs. (per sq. ft) | 2" | 4" | 4" | 4" |
| Available Fabric Choices | Various | Various | Various | Various |
| Framing Color | White | White | White | White |
| Housing Dimensions in Inches | 10' x 10' | 22' x 10' | 22' x 10' | 14' x 26' |
| Power Requirements | 120V | 120V | 120V | 120V |
| Safety Features | | | | |
| Infrared Sensor | ✓ | ✓ | ✓ | ✓ |
| Back Up Operation When Sensor Triggered | ✓ | ✓ | ✓ | ✓ |
| Additional Features | | | | |
| Smart Device Integration | ✓ | ✓ | ✓ | ✓ |
| Modular Design for Auto-Leveling | ✓ | ✓ | ✓ | ✓ |
| Sealed Border | ✓ | ✓ | ✓ | ✓ |
| Tight Stretch Magnets | ✓ | ✓ | ✓ | ✓ |
| Product Finishing | Single Sided | Dual Sided | Dual Sided | Dual Sided |
| Quiet Open | ✓ | ✓ | ✓ | ✓ |
| 1 Touch Remote Controlled | ✓ | ✓ | ✓ | ✓ |
| Patented Griprail Technology | ✓ | ✓ | ✓ | ✓ |
| Modular Delivery | | ✓ | ✓ | ✓ |
| Smart Device Integration | ✓ | ✓ | ✓ | ✓ |

