

## BUSINESS ENVIRONMENT

Tudelü system's provides a balance of aesthetics, functionality, and versatility, making them an excellent choice for creating collaborative, private, or multi-purpose spaces with minimal disruption.

## TUDELÜ SYSTEM BENEFITS

### 1 SPACE FLEXIBILITY

Retractable walls provide the ability to easily divide or combine spaces, adapting to the changing needs of a business. This allows for quick transformations of the environment, whether for meetings, presentations, or collaborative work.

### 2 SOUNDPROOFING

These walls often include advanced soundproofing materials, offering noise isolation and privacy between rooms. This feature is crucial in business settings where confidentiality and concentration are important.

### 3 EASE OF USE

Retractable walls are designed for easy operation, either manually or through automated systems. They can be deployed and retracted quickly, making them convenient for frequent use in dynamic workspaces.

## OUR SERVICES



### AMERICAN

Engineering, design, and manufacture all done in the USA



### MOTORIZED

100% remote controlled for zero manual effort



### COMPACT

Full system has tiny footprint in ceiling, starting from 10" x 10"



### INSTALLABLE

Easy install for new construction and retrofitting



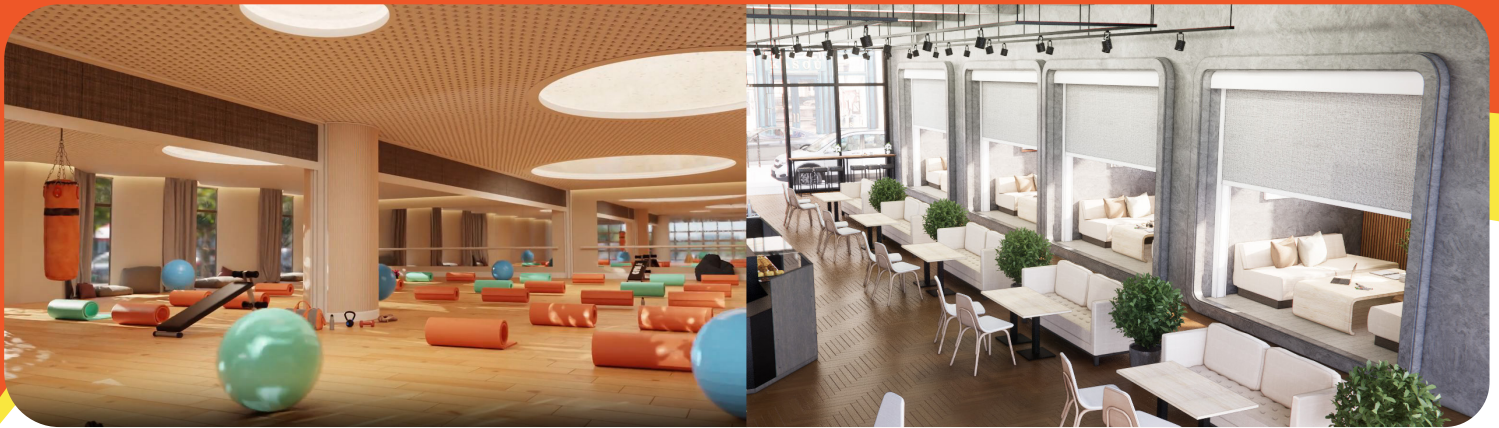

## Key Benefits of the Tudelü Systems

Customizable Sizes of up to 20ft wide x 10ft tall

36 - 48 True STC sound barrier for effective sound reduction. This is the same noise reduction as traditional dry wall.

Easy Installation, either through Tudelü direct or through our step-by-step instructions.

100% Motorized - anyone can operate this product with a simple press of a button.

Durable Material - including powder coated extruded aluminum.

Patented Technology - including Stable Griprail Technology.

Compact Footprint - featuring inset design options, meaning ZERO eye sores.

Seamless Design - No matter your dimensions, Tudelü walls won't hurt your aesthetic.

Built-in Safety - auto open feature when the system feels the slightest resistance, so you and your furniture are both safe.

Easy Maintenance - simple soap and water will keep your system looking new for years to come.

Technical Information	Closure	Private	Secluded	Mute
STC of System	-	36	38	48
OTC of System	-	22	30	30
Max Height in feet	10'	10'	12'	15'
Max Width in feet	20'	20'	20'	40'
Wall Thickness in inches	2"	4"	4"	4"
Weight of Wall Fabric in lbs. (per sq. ft)	2"	4"	4"	4"
Available Fabric Choices	Various	Various	Various	Various
Framing Color	White	White	White	White
Housing Dimensions in Inches	10' x 10'	22' x 10'	22' x 10'	14' x 26'
Power Requirements	120V	120V	120V	120V
Safety Features				
Infrared Sensor	✓	✓	✓	✓
Back Up Operation When Sensor Triggered	✓	✓	✓	✓
Additional Features				
Smart Device Integration	✓	✓	✓	✓
Modular Design for Auto-Leveling	✓	✓	✓	✓
Sealed Border	✓	✓	✓	✓
Tight Stretch Magnets	✓	✓	✓	✓
Product Finishing	Single Sided	Dual Sided	Dual Sided	Dual Sided
Quiet Open	✓	✓	✓	✓
1 Touch Remote Controlled	✓	✓	✓	✓
Patented GripRail Technology	✓	✓	✓	✓
Modular Delivery		✓	✓	✓
Smart Device Integration	✓	✓	✓	✓

